

# Maintenance

**The vehicle should be checked for damage, missing or badly worn parts before each use.**

- Check the tightness of the fasteners before each use.
- Check the tightness of the wheel locknuts. Note: If the wheel locknuts are not tight the drive wheel will not engage and the vehicle will not run.
- Ensure the battery is securely in place before use.
- Occasionally use lightweight oil to lubricate moving parts such as wheels and steering linkage. Do not use oil on plastic or nylon parts. No lubrication is required.
- Store the vehicle indoors or cover it with a tarp to protect it from the wet weather. Keep it away from sources of heat, such as stoves and heaters.
- Clean the vehicle with a soft, dry cloth. To restore shine to plastic parts, use a non-wax furniture polish. Do not use car wax, abrasive cleaners or wash the vehicle with soap and water. Water will damage the motor, electrical system and battery.

# Owner's Manual



# ZLG-8588

- Strong woofer speaker, 3D surround sound.
- Both side doors can be open, suspension on
- four wheels, cool LED lights
- Rocking function for selection

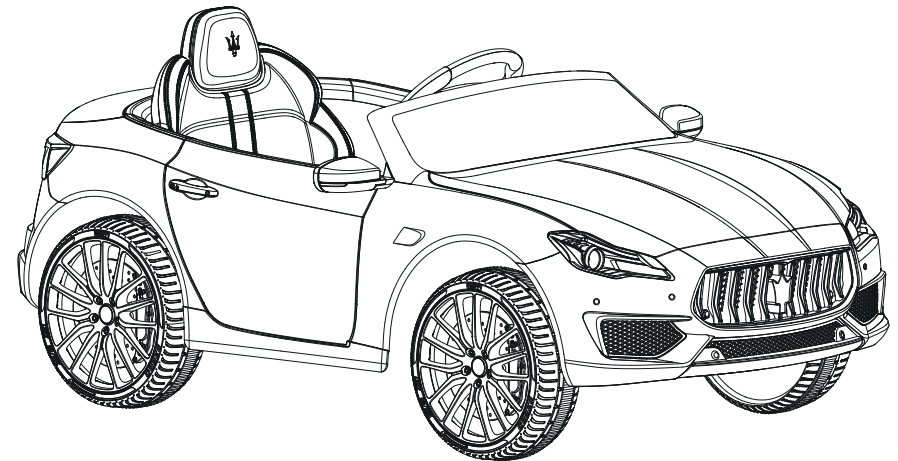

## Thanks for choosing our ZLG-8588 Authorized children's ride-on vehicle!

Please read the user manual before use. The Owner's manual contains assembly, use and maintenance instructions. The vehicle must be assembled by an adult who has read and understands the instructions in this manual. Keep the packaging away from children and dispose all packaging before use. Keep instructions for future reference.

### Specifications

Name	Specification
Battery	12V
Age for	37-95 Month
Weight capacity	35kg
Speed	3-5km/hr
Battery for remote control	AAA 1.5V*2



**WARNING!** CHOKING HAZARD –Small parts. Not for children under 3 years! Please tidy up the small parts in time!  
• **WARNING!** Please check if anywhere have sharp edge and burr before assembly, the small parts need to be keep away from the children under 3 years to prevent injury!

**WARNING!** The product must be assembled by an adult!

#### **WARNING! To avoid accident:**

- The toy should be used with caution since skill is required to avoid falls or collisions causing injury to the user or third parties.
- Always ride the vehicle under adult's supervision and guide. Don't leave your child alone and please always keep the rider in sight.
- Always use the vehicle in a safe, secure environment, never ride the vehicle on high way, around cars and steps.
- Always wearing shoes when riding the vehicle.
- Always keep the child sit on the seat when riding the vehicle, and fasten the seat belt.
- The suitable age for this vehicle: 37-95 months  
The maximum capacity: 35KGS.

**WARNING! Not to be used in traffic.**

**WARNING! This toy has no brake.**



## Parts List for Packing

NO.	PART NAME	QTY (unit: pc)	REMARK
		Two driver motor	
1	Vehicle body	1	
2	Reflectors	2	
3	Steering wheel	1	
4	Gear box	3	Steering motor included
5	Seat	1	
6	Windshield	1	
7	Wheels	4	Include wheel cover and decoration parts on wheels
8	Charger	1	
9	Remote	1	If select manual vehicles, without remote
10	Lead acid battery	1	
11	Manual	1	

### SMALL PARTS ACCESSORIES BAG

NO.	PART NAME	QTY (unit: pc)	REMARK
		Two driver motor	
1	Φ 12mm washers cotter pin	4	Use the front axle rear axle
2	Φ 4*12 self driver screws	6	Lock the seat use: tow big flat head Lock the mirror use: four round head
3	Φ M5*40 nut	1	Lock steering wheel use

## WARNING FOR USE

Confirm below already finished before use:

- Before using the vehicle for the first time the battery needs to be charged for 16 hours.  
Only charge by adult! Failure to do so may damage the battery and can't be repaired.
- Assembly the vehicle according to the assembly steps, make sure all the plugs on battery already connected.
- Make sure all the screws are tight to fit the parts in certain position.

## WARNING!

- Please tell the safe rules to your child and playmates, make sure they understand!  
Make sure your child use the vehicle in a safe, secure environment, such as in house, garden or playground.
- Note the vehicle can only ride on hard and smooth ground, to ensure safety, never ride under below environment:  
A.Drop-offs such as: steps, water (swimming pools), sloped surfaces, hills, moats.  
B.Streets or any place cars, motor vehicles and people may appear.  
C.Any obstructions may course impact.  
D.Other places not safety.
- Avoid to use the vehicle at night or in the dark, the child may can't treat the obstruction they meet, only use the vehicle in day time or in the bright area. .
- Never use the vehicle outdoor in the rain or in the snow.
- Make sure the vehicle completely stopped before change the shifts.
- Make sure the rider suitable for right ages, only one rider use the vehicle, please not over load, the maximum capacity is 35KGS.
- Do not change the wires of the vehicle and add electrical parts.
- Please don't use in the rain or immerse the vehicle by other way, and also keep away from the fire to prevent the circuit damaged.
- Once come to an obstacle, the vehicle will stop move, please leave the obstacle then ride again.
- Don't ride the vehicle in the water, and not pour water and other liquid on the vehicle.
- Don't use the vehicle indoor to prevent damage the furniture or hurt the child.
- If the power of remote control battery is not enough, the vehicle can only move forward and backward, but can't turn left and right. The remote distance will be shorter and the vehicle may move not smoothly, please change the batteries urgently!
- Close the power switch if not use the vehicle. For a long time not use, please cut off the plugs for the battery.
- Once the vehicle speed is obviously be slow, the motor is not strong, and the music sound been lower,
- please charge the battery in time!

## PART LIST

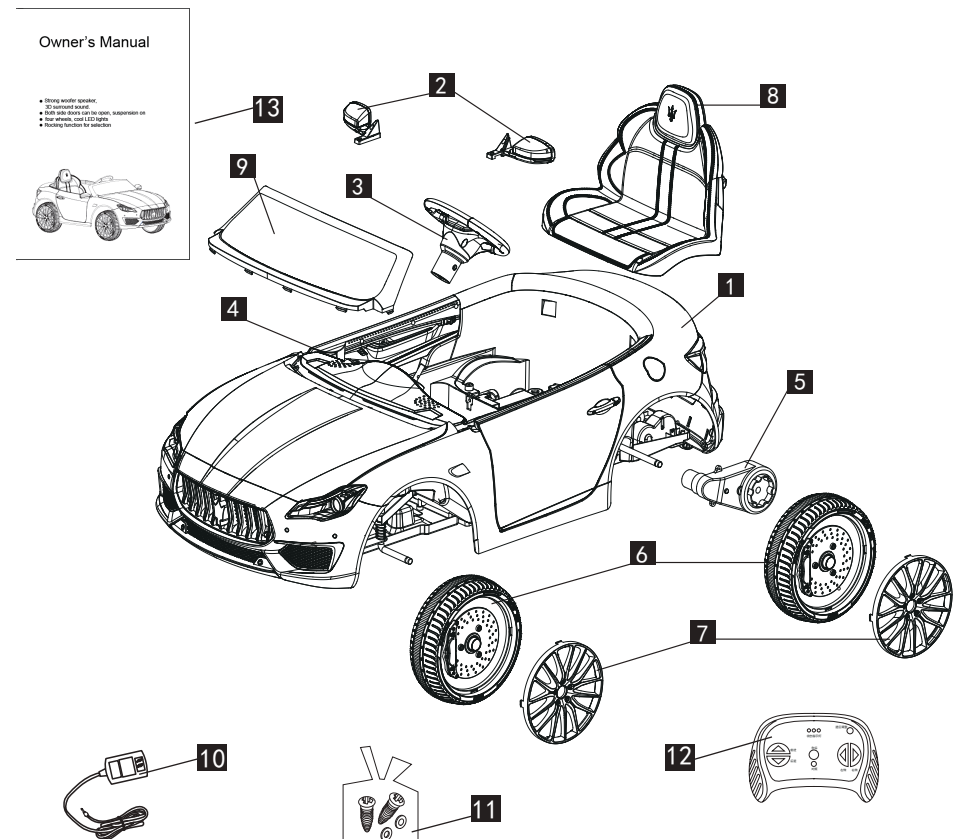

1	Vehicle body	5	Driver gear box	9	Windshield	13	Manual
2	Reflectors	6	Wheels	10	Charger		
3	Steering wheel	7	Wheel cover	11	Accessories bag		
4	Buttons for sound	8	Seat	12	Remote control		

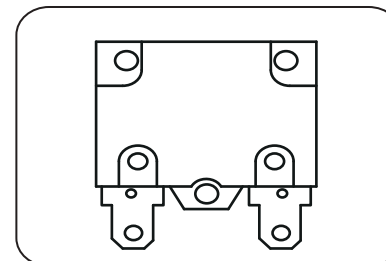

**Notice: Self-resetting fuse**  
The self-resetting fuse have the function of self cut off and self reset the power.

## assembly front wheel:

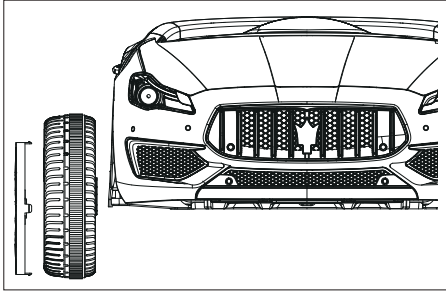

- 1.insert a gasket( $\phi 12$ ) and a falt wheel insert into the front axle,
- 2.then insert a gasket( $\phi 12$ ) and cotter pin,then bending the cotter pin until can't take out.
- 3.Attach the wheel cover onto the wheel,make all the grooves fit well and haer the sound of a cilck.
- 4.other side wheel as the same.

## assembly rear wheel:

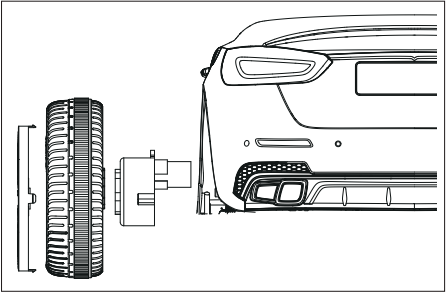

- 1.install the driver gear box on to the rear axle from left of the body (make sure the terminal of the motor wire through into the battery are).
- 2.install the driver wheel ,make it fit well the motor. then insert a gasket( $\phi 12$ ) and cotter pin,then bending the cotter pin until can't take out.
- 3..Attach the wheel cover onto the wheel,make all the grooves fit well until haer the sound of a cilck.
- 4.other side wheel as the same.

## assembly the steering wheel :

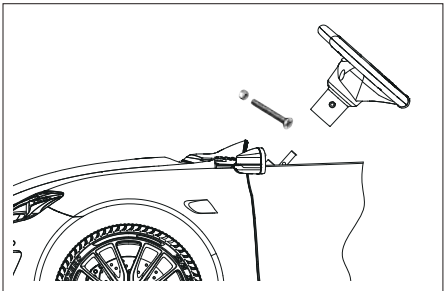

- 1.remove the long bolt ( M5\* 40mm ) from the steering wheel.
- 2.connect the terminals of the wires from steering wheel and dashboard,then the steering wheel insert into the steering axle,and make the hole of the steering wheel and hole of the axle in a line. last insert the long bolt to through the holes and tighten a M5 nut.

## assembly the rear-view mirror and windscreen :

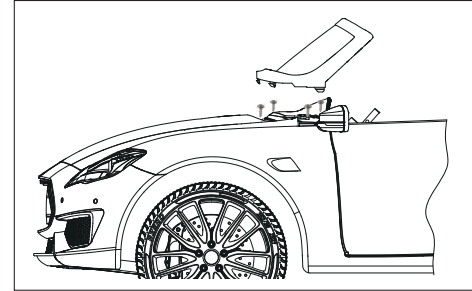

- 1.install the rear-view mirror onto the body ,then tighten the screws (M4\*12)
- 2.other side as the same.
- 3.Attach windscreen onto thebody,make all the grooves fit well until haer the sound of a cilck.

## assembly the seat :

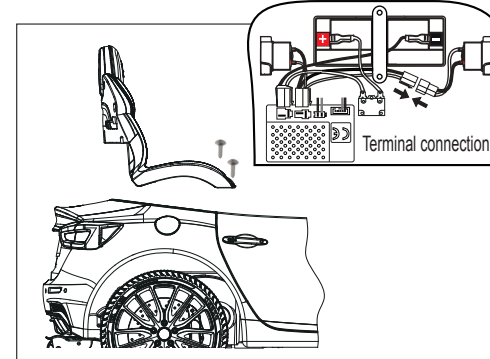

- 1.motor connect terminal according to the color of the corresponding plug(blue to blue/white to white)before installing the seat.
- 2.insert the red positive wire into the Positive terminal of battery.
- 3.remove the screws (M4\*12mm)on the body ,then insert back of seat into the holes of body, last Tighten the screws that has just been unloaded.

## Function instruction

Press the buttons on the steering wheel, there will be horn sound or music (press music button shortly will go next song). Press left button of the steering wheel for a long time will add volume while press right button for long time will reduce the volume.

Different sounds: the music PCB on dashboard have different sounds by press different button; Power display; Volume adjustment; with MP3/USB/ SD card socket.

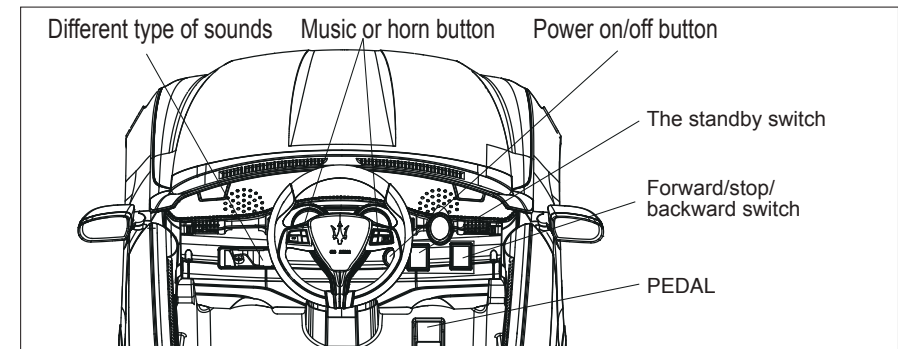



## How to use the remote control

As picture below: Open the battery box cover of the rear side, insert two AAA batteries then fix the battery box cover by screw. The buttons on the front side of the remote control can control the vehicle function of code setting (Notice: Set code according to the instruction on the rear of remote. ), forward, backward, turn left or right, change different speed (with three speed and soft start) and suddenly stop.

**WARNING!** Make sure the polarity of the battery is correct, please according to the mark of the battery box.

**WARNING!** Different types of batteries or new and used batteries are not to be mixed;

The supply terminals are not to be short-circuited;

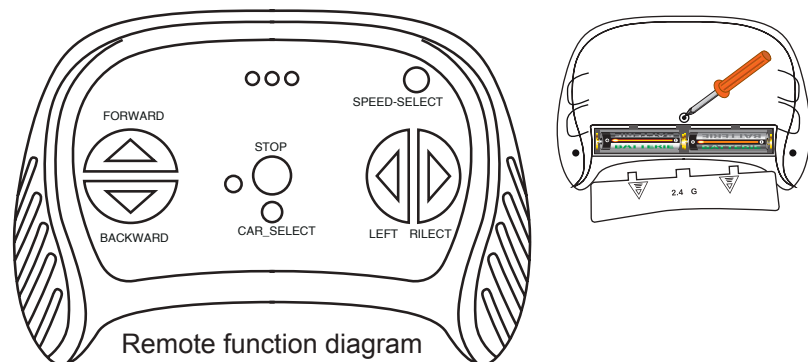

**WARNING!** The remote can control the vehicle even when the car used by manual, to ensure the child's safety, please use the remote function by adult. Child can only manual use the vehicle.

This vehicle use 2.4G blue tooth remote control, the remote is unique for the vehicle and the vehicle can only be controlled by the certain remote (please set code according to the instruction on rear side of the remote). After code setting, the remote can control vehicle to go forward, backward, turn left and right, change speed and urgent stop (Remote is preferred for the electrical system). Set the forward/stop/backward switch at forward position, press the pedal by the foot, the vehicle will move forward, set the switch at backward position, press the pedal the vehicle will move backward, and set the switch at stop position, the vehicle will stop.

## WARNING FOR REMOTE BATTERY

Don't mix up different type of the batteries, also don't mix use the new and old batteries.

Never make the batteries be short circuit.

Never charge the non-chargeable batteries.

Take the rechargeable batteries from the toy before charging.

Insert the batteries at the correct polarity.

Only charge the rechargeable batteries by adult.

Take the power off batteries out from the toy, properly treat them and prevent the child to play them.

Take the batteries out and collect them well once long time not use.

## HOW TO CHARGE

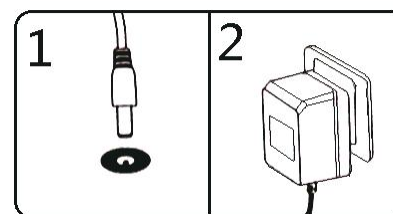

- Close the power before charging.
- The charge socket located at the lower position of the seat
- Open the cover of the charger socket, insert the round plug of charge into the charge socket.
- Insert the charger plugs into the power socket. Notice: Only charge by adult!

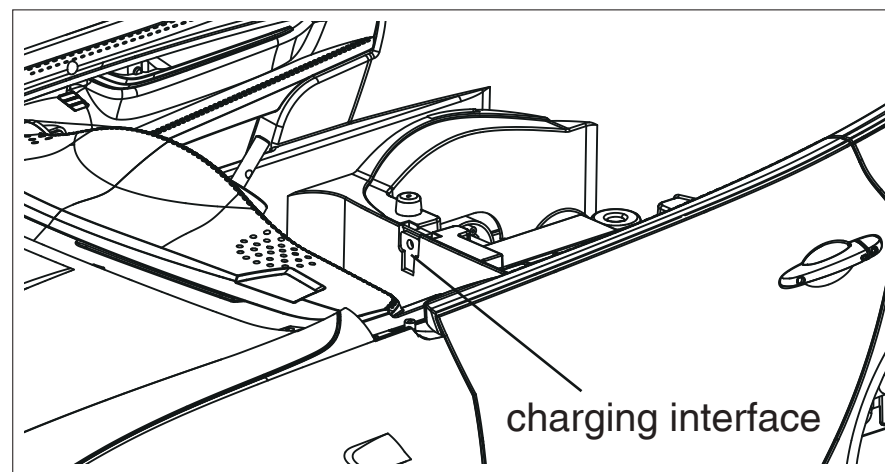

## Warning for Charging the battery

- Insert the charger plug into charge hole on vehicle body first, then connect the other end with power supply.
- Charge the vehicle when each use after 1hour, normal charging time is 10 to 12 hours.
- Each charge no more than 20 hours.
- Only an adult who has read and understands the safety warnings should handle, charge or recharge of the battery.
- If the vehicle won't use for a long time, it need to be charged at least once per month.
- The charger and the battery may be a little heatingup, it will be acceptable if the temperature less than 60°C.
- The charging hole and jack can't be damp or it may cause short -circuit.
- Only charge the vehicle by proprietary charger which sell with the product.
- **Note:** It is not necessary to remove the battery from the vehicle for charging.

**WARNING!** The following safety hazards may result in serious injury or death to the child, please note below:

- There is a small accessories bag attached with the vehicle, some small parts included, please keep it away from the children to prevent choking! Never let children touch and play the small parts.
- Check the parts quantity before assembly. Keep away the child from protective material and poly bags to prevent suffocation!
- Only charge the battery by an adult. Please charge the battery before first use!
- Regularly check the product including charger, wires, vehicle body and other parts, once found damage, please stop to use until mend it well.
- Two AAA 1.5V dry batteries is needed for remote control.
- Ensure the polarity is right when inserting the dry batteries, once the power is used off please take them out.
- Adult assembly only! It will takes about 30 minutes for assembly.

## Troubleshooting Guide

Error type	Reason analysis	Elimination method
Vehicle doesn't move	1. Low battery voltage 2. Fuse protecting 3. Wheel nut off 4. Battery connectors off 5. Battery broken 6. Electrical euipment damaged 7. Motor broken 8.Abnormal power remote control	Charge the battery Restart it after Stopping some minutes Screw the nut again Plug again Change the new battery Send to repair shop for repairing Send to repair shop for repairing Again according to the remote control of frequency
Battery charging failed	1. Battery connectors off 2. Charger is not connected 3. Charger broken	Plug again Plug again Change the charger
Short mileage range	1. Battery is not charged fully 2. Battery is old	Charge the battery fully Change new battery
Battery has slight noise and heating while charging	1. It is chemical reaction	Normal
Slow speed	1. Battery is old 2. Low battery voltage 3. Overload 4. Road roughness	Change new battery Recharge the battery Reduce the load to 25kg Drive on smooth road
Gearbox has noise	1. Gear broken	Send to repair shop for repairing
Vehicle shaking while moving	1. Bad motor connecting line 2. Dead point in motor	Connect again Send to repair shop for repairing
No voice while vehicle moving	1. Steering wheel connector off	Plug again
Vehicle can't be stopped	1. Electrical euipment damaged	Send to repair shop for repairing
For elimination method above, please contact the distributor for reparation when the consumer doesn't have repairing condition.		